

# SPS-24/1,5

- ▣ single output, industrial DIN rail power supply
- ▣ universal AC input / full range
- ▣ protections: short circuit / overload / over voltage
- ▣ LED indicator for power on
- ▣ 100% full load burn-in test



Din Rail power supplies are a fanless design for installation on TS35/7,5 or TS35/15 industrial rails available as a slim line 30 Watt unit. Known uses include general industrial applications including factory automation, electro-mechanical industry, data communications, IT, power distribution boxes, control panels, building automation and household appliance control.

- cooling by free air convection,
- can be installed on DIN rail TS-35/7,5 or 15,
- UL 508 (industrial control equipment) approved,
- isolation class II.

## Block diagram

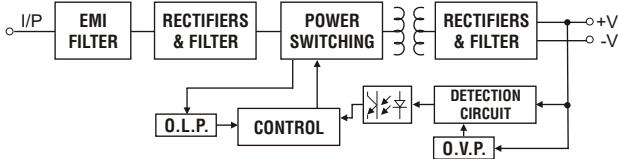

## Output derating

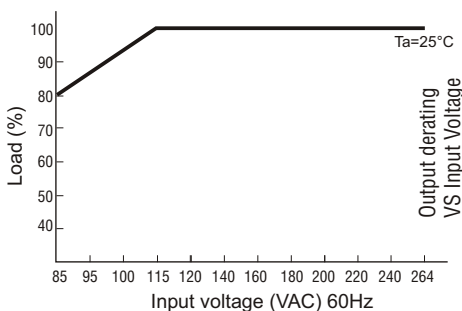
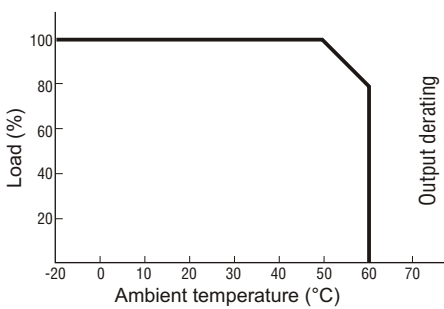

## Ordering

SPS-24/1,5

## Pin assignment and dimensions

Pin No.	Assignment
1	AC/N
2	AC/L
3,4	+V
5,6	-V
7	LED
8	V ADJ.

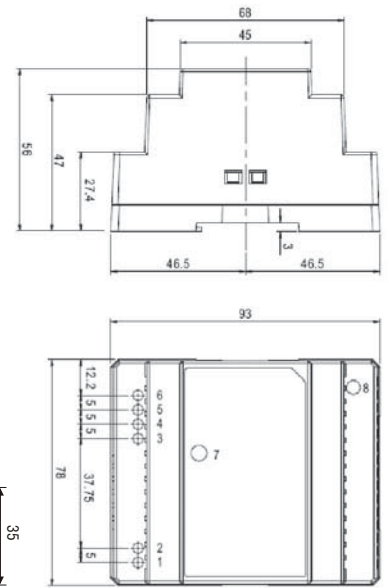

## Technical data

### Output:

- DC voltage: 24 V
- Rated current: 1,5 A
- Current range: 0 - 1,5 A
- Rated power: 36 W
- Ripple & noise (max.): 150mVp-p
- Voltage adj. Range: 21,6 - 26,4 V
- Voltage tolerance: ± 1%
- Line/load regulation: ± 1%/± 1%
- Setup, rise time: 100ms, 30ms/230VAC; 100ms, 30ms/115VAC at full load
- Hold time (typ.): 100ms/230VAC; 21ms/115VAC at full load

### Input:

- Voltage range: 85 - 264 VAC; 120 - 370 VDC
- Frequency range: 47 - 63 Hz
- Efficiency (typ.): 83%
- AC current (typ.): 0,88A/115VAC; 0,48A/230VAC
- Inrush current (typ.): COLD START 15A/115VAC; 30A/230VAC

**Overload protection:** 105 - 160% rated output power; protection type: constant current limiting, recovers automatically after fault condition is removed

**Over voltage protection:** 27,6 - 32,4 V; protection type: shut down o/p voltage, repower on to recover

**Working temperature:** -20°C - +60°C (Refer to output load derating curve)

**Working humidity:** 20 - 90% RH non-condensing

**Storage temperature:** -40°C - +85°C

**Storage humidity:** 10 - 95% RH

**Temperature coefficient:** 0,03%/°C (0 - 50°C)

**Vibration:** 10 - 500Hz, 2G 10min./1cycle, period for 60min. each along X, Y, Z axes

**Weight:** 0,27 kg

**Dimensions (W x H x D):** 78 x 93 x 56 mm

**Safety standards:** UL60950-1, TUV EN60950-1 Approved, Design refer to EN50178

**EMC:** EN55022 class B, EN61000-3-2,3, EN61000-6-2, EN61000-4-2,3,4,5,6,8,11, ENV50204, EN61204-3